



COPPUS DOUBLE-DUTY™ HEAT KILLER

Powerful industrial fan for cooling products processes and personnel

MODEL/SPECIFICATIONS

ADJUSTABLE GUIDE VANES

Adjustable guide vanes create a number of airflow patterns from gentle breeze to jet blast. Most efficient air flow can be determined by positioning guide vanes during operation.

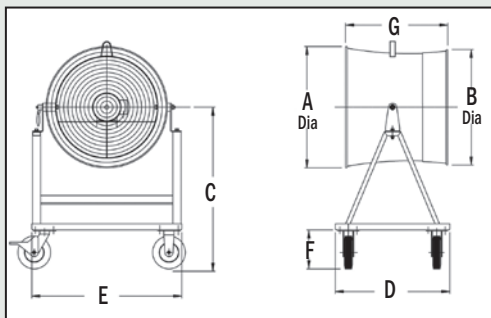
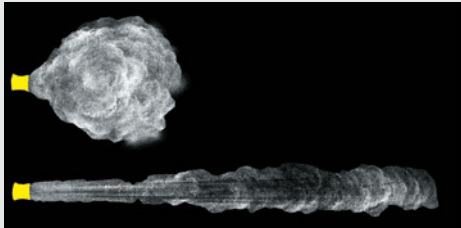

DESCRIPTION

With airflows up to 17,000 cfm (28,890 m³/hr) the Double-Duty™ Heat Killer (DDHK) is one of the most powerful and versatile portable air movers on the market today. The patented, adjustable guide vane design allows air flow control—from a gentle breeze for personnel cooling, to a concentrated jet blast for product and process cooling.

FEATURES / ADVANTAGES

- Adjustable guide vanes allow varied air movement from a gentle breeze to a jet blast
- Available in 24 in (610 mm) and 30 in (762 mm) models
- Available in floor stand or wall mount models
- Heavy-duty, rugged steel housing and frame
- Protective screens meet OSHA guidelines
- Available with TE and EP motors
- Hazardous location switches and motors meet NEC Class I, Division I, Group D and Class II, Division I, Groups F and G specifications
- Thermal overload protection on motors

**Note: EP plugs sold separately to meet local codes*

DIMENSIONS

| FLOOR STAND DIMENSIONS | | | | | | | | |
|-------------------------|-------------|-------------|---------------|-------------|-------------|------------|-------------|-------------------|
| FAN SIZE | in/mm | | | | | | | NET WT lbs/kgs |
| | A | B | C | D | E | F | G | |
| 24 in 610 mm | 29.6 752 | 28.3 719 | 39.5 1,003 | 28.0 711 | 36.5 927 | 9.5 241 | 25.0 635 | 250 113 |
| 30 in 762 mm | 36.8 935 | 33.4 848 | 39.5 1,003 | 28.0 711 | 36.5 927 | 9.5 241 | 28.0 711 | 340 154 |

TECHNICAL DATA

| AIR VELOCITIES FPM (M/MIN) AT VARIOUS DISTANCES FROM FAN | | | | | | | | | | | | |
|--|----------|--------------------|--------------|--------------|--------------|--------------|---------------|------------|---------------|------------|---------------|------------|
| MODEL | Free Air | | 10 ft 3 m | | 30 ft 9 m | | 50 ft 15 m | | 70 ft 21 m | | 90 ft 27 m | |
| | cfm | m ³ /hr | JB | DF | JB | DF | JB | DF | JB | DF | JB | |
| 24K10D | 50 Hz | 7,917 | 13,450 | 1,396 423 | 558 169 | 700 213 | 313 95 | 467 142 | 233 71 | 292 88 | 192 58 | 154 47 |
| 30K30D | | 14,167 | 24,075 | 1,875 572 | 1,067 325 | 833 253 | 433 133 | 750 228 | 283 87 | 583 178 | 258 79 | 396 121 |
| 24K10D | 60 Hz | 9,500 | 16,140 | 1,675 508 | 670 203 | 840 255 | 375 114 | 560 170 | 280 85 | 350 106 | 230 70 | 185 56 |
| 30K30D | | 17,000 | 28,890 | 2,250 686 | 1,280 390 | 1,000 304 | 520 159 | 900 274 | 340 104 | 700 213 | 310 95 | 475 145 |

JB = jet blast
DF = diffused flow

| FREE AIR DECIBEL LEVELS | |
|-------------------------|--------|
| 24K07D | 79 dBA |
| 24K10D | 85 dBA |
| 30K30D | 92 dBA |

| PERFORMANCE SPECIFICATIONS | | | | | | |
|----------------------------|----------|-----|-------|-------|------------|--------------------|
| MODEL | FAN SIZE | | MOTOR | | AIR VOLUME | |
| | in | mm | HP | rpm | cfm | m ³ /hr |
| 24K07D | 24 | 610 | 3/4 | 1,750 | 7,100 | 12,060 |
| 24K10D | 24 | 610 | 1 | 1,750 | 9,500 | 16,140 |
| 30K30D | 30 | 610 | 3 | 1,750 | 17,000 | 28,890 |

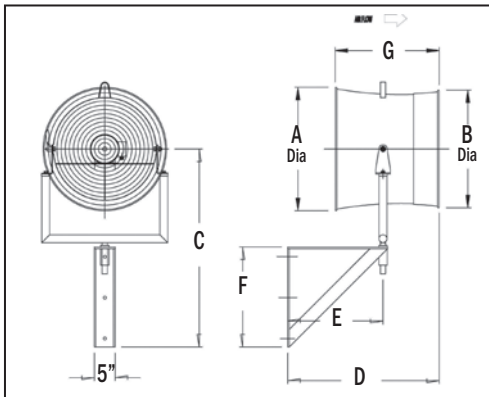

| WALL MOUNT DIMENSIONS | | | | | | | |
|-----------------------|-------------|-------------|--------------|--------------|-------------|-------------|-------------|
| FAN SIZE | in/mm | | | | | | |
| | A | B | C | D | E | F | G |
| 24 in 610 mm | 29.6 752 | 28.3 719 | 47.6 1208 | 36.4 925 | 22.9 582 | 24.0 610 | 25.0 635 |
| 30 in 762 mm | 36.8 935 | 33.4 848 | 52.7 1338 | 39.6 1006 | 25.1 638 | 26.1 664 | 28.0 711 |

DDHK WALL MOUNT KIT

Easy retrofit wall mount kits are available for existing floor stand models; kits include wall bracket and fan U-bracket.

- Frees up valuable floor space
- Ensures permanent location
- Design permits 360 degree rotation with variable tilt up or down of 155 degrees (90 degrees down, 65 degrees up)

